

Nokia Essential True Wireless Earphones T3030

User guide

Contents

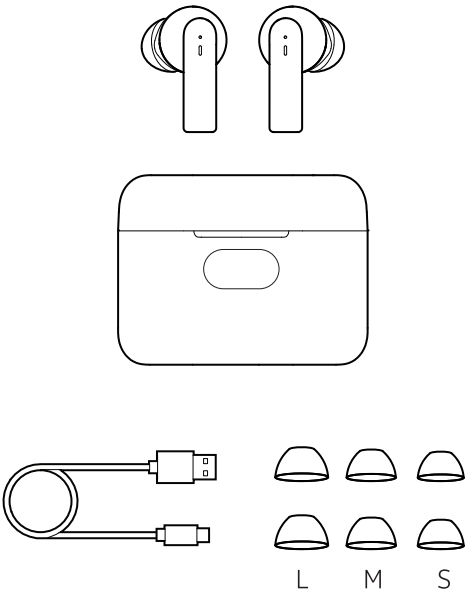

Powering on

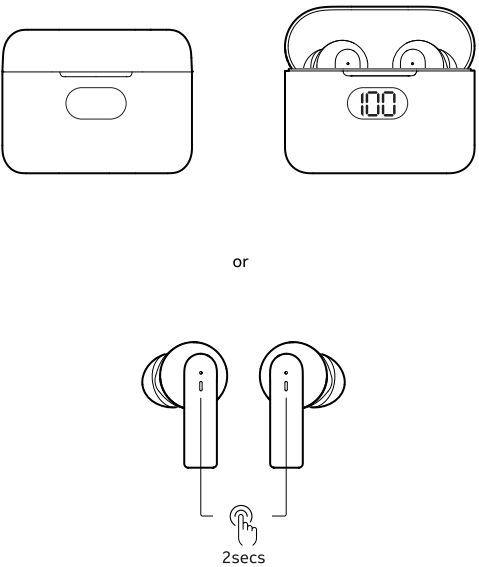

Pairing mode

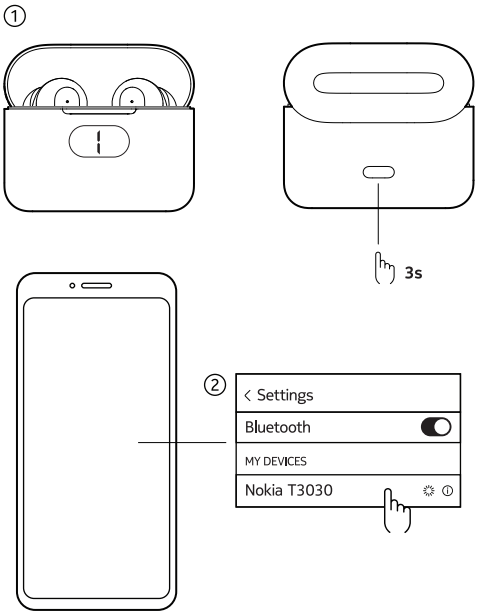

Charging

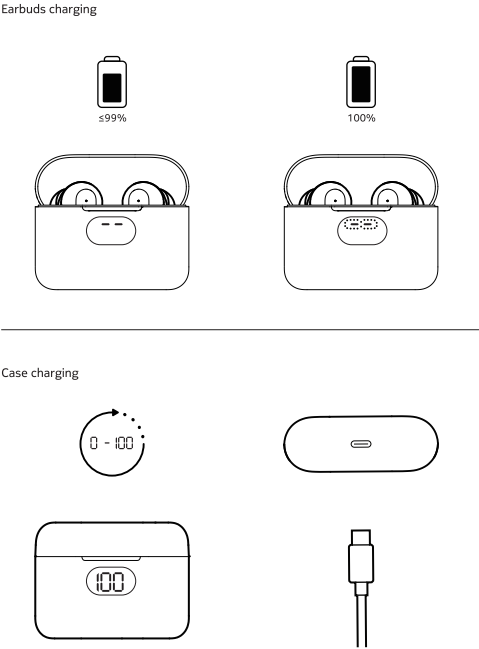

Reset

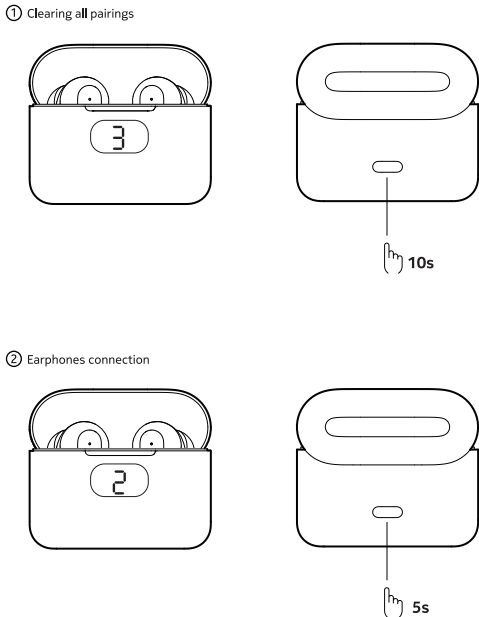

Controls

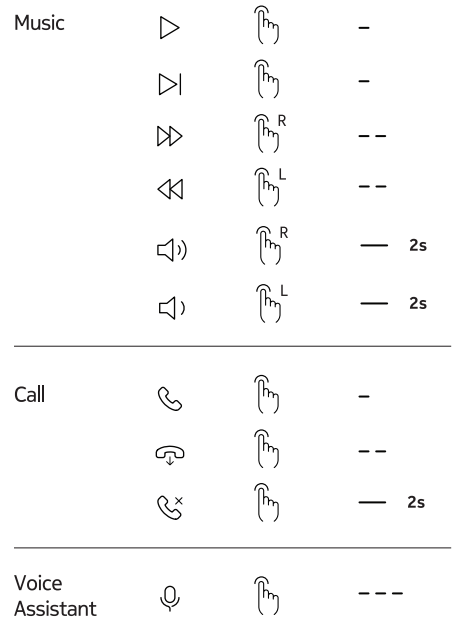

Specifications

<b>Nokia Essential True Wireless Earphones T3030</b>	
Wearing style	: True wireless earphones
Ear coupling	: Ear canal
Frequency response	: 20Hz to 20kHz
Transducer principle	: Dynamic driver
Transducer size	: 13mm
Sound pressure level(SPL)	: 94dB±3dB
Impedance	: 16Ω±15%
Microphone principle	: MEMS x 2
Power supply	: Built-in Lithium rechargeable batteries, 3.7V
	Left earbud: 40mAh
	Right earbud: 40mAh
	Charging case: 350mAh
Operating time	: Up to 5hrs (music playback via A2DP) with rechargeable batteries of the earphones*
	Up to 20hrs with rechargeable battery of the charging case*
Charging time	: Earphones: approx. 2hrs
	Charging case: approx. 2hrs
Ingress protection (earbuds)	: Anti-dust and splash proof (IP44)
Weight	: Left earbud; approx. 4g
	Right earbud; approx. 4g
	Charging case; approx. 32g
Volume Control	: Yes
<b>Bluetooth</b>	
Version	: Bluetooth specification version 5.1
Profiles	: HSP, HFP, AVRCP, A2DP
Effective Range	: GFSK, π/4 DQPSK, 8DPSK
Transmission frequency	: 2402MHz to 2480MHz
Output power	: 3mW (max.)
Supported Audio Format(s)	: SBC

\* Charging case that holds multiple charges for having the total play time. Battery life depends on device settings, environment, usage and many other factors.

Troubleshooting

Problem	Reason	Solutions
Does not power on / Does not respond	Battery is low	Charge the earphones for 2 - 3 hours and restart the earphones
No sound after pairing	Incorrect pairing	Pair the earphones again or reset the earphones
Turns off automatically	Battery is low	Charge the earphones for 2-3 hours
Failing to charge	Error with power supply	Perform a hardware reset
No light on the case during charging	Error with power supply	Check whether the charging cable is plugged in. Ensure the switch button is turned on.
Hearing an echo	Volume is too loud or the environment is too noisy	Adjust the volume or change your location
Noise in-call / Sound occasionally drops	Noisy environment or distance between earphones and mobile phone is too far	Change your location or bring your earphones and mobile phones closer together
Sound is too soft	Low volume	Increase the volume
Pairing unsuccessful / Only one side has sound / Cannot find the pairing name on the device / Mono pairing unsuccessful	Reset the earphones / Reconnect the earphones again	Reset and reconnect the earphones
Earphones don't power on when removing from the charging case	Charging case is low in battery	Charge the earphones and the charging case for 2-3 hours

Safety Guide

<b>Important safety instructions</b>	
<ul style="list-style-type: none"><li>Read the user guide &amp; warranty manual (as supplied) carefully and completely before using the product.</li><li>Always include this safety guide when passing the product on to third parties.</li><li>Do not use an obviously defective product.</li><li>Use only the product in environments where wireless Bluetooth transmission is permitted.</li></ul>	
<b>Preventing damage to health and accidents</b>	
<ul style="list-style-type: none"><li>Do not listen at high volume levels for long periods of time to prevent hearing damage.</li><li>The product generates stronger permanent magnetic fields that could cause interference to cardiac pacemakers, implanted defibrillators (ICDs) and other implants. Always maintain a distance of at least 3.94" (10cm) between the product component containing the magnet and the cardiac pacemaker, implanted defibrillator or other implant.</li><li>Keep the product, accessories and packaging parts out of reach of children and pets to prevent accidents. Swallowing and choking hazard.</li><li>Do not use the product in an environment that requires your special-attention (e.g. in traffic).</li></ul>	
<b>Preventing damage to the product and malfunctions</b>	
<ul style="list-style-type: none"><li>Always keep the product dry and do not expose it to extreme temperatures (hairdryer, heater, extended exposure to sunlight, etc.) to avoid corrosion or deformation. The normal operating temperature is from 0 °C to 40 °C/32 °F to 104 °F.</li><li>Use only attachments, accessories, spare parts supplied or recommended by Flipkart.</li><li>Only clean the product with a soft, dry cloth.</li></ul>	
<b>Safety instructions for lithium rechargeable batteries</b>	
<p><b>WARNING</b></p> <p>In extreme cases, rechargeable batteries may leak and may cause the following hazards if abused or misused:</p> <p>explosion · fire development · heat generation · smoke or gas development</p>	
	Dispose of defective products with built-in rechargeable batteries at special collection points or return them to your specialist dealer.
	Only use rechargeable batteries recommended by Flipkart and the appropriate chargers.
	Only charge the product / rechargeable batteries at ambient temperatures between 10°C/50°F and 40°C/104°F.
	Switch battery pack-powered products off after use.
	When not using for extended periods of time, recharge the product / rechargeable batteries regularly (about every 3 months).
	Do not heat the product / rechargeable batteries above 70 °C/158°F. Avoid exposure to sunlight and do not throw the product / rechargeable batteries into fire.

Flipkart India Private Limited is a licensee of the Nokia brand in India. Nokia is a registered trademark of Nokia Corporation.  
All trademarks are the property of their respective owners.

**Intended use/Liability**  
Flipkart will not be responsible for any indirect or consequential loss, loss of profits or loss of data. Warranty will be void under the following conditions, and manufacturer reserves the right to refuse to provide service and to demand charges for any costs of servicing from the customer.  
There will be no warranty if the product has been modified or repaired by persons not authorized by manufacturer; Mishandling or wrong application of product, such as leaving batteries over an extended period in the product causing battery fluid leakage, or applying wrong voltage, manual destruction, damage caused by natural disaster or accident; caused by impact sand or liquid damage, tampering, or operating fail; install and maintain product without following instructions provided by the manufacturer; if the model number or item code attached with the product has been erased or modified; Modify without authorization the contents of this warranty policy.  
If the product have been used for commercial, display, demonstration or rental purpose. All parts replaced within the warranty period are properties of manufacturer. We have the right to handle those parts as necessary.  
Warranty covers only the hardware of the product's mainbody. All other accessories are not covered within the warranty terms, such as external connection cable, power cable, computer cables, software, CD, external cover/cabinet and user manual. (For item description and accessories, please refer to the user manual/instruction manual/user guide)

**Manufacturer Declarations**  
More information on legal compliance labels can be found at bottom.

Always return your used electronic products, batteries, and packaging materials to dedicated collection points. This way you help prevent uncontrolled waste disposal and promote the recycling of materials. Electrical and electronic products contain a lot of valuable materials, including metals (such as copper, aluminum, steel, and magnesium) and precious metals (such as gold, silver, and palladium). All materials of the device can be recovered as materials and energy. The crossed-out wheellie bin symbol on your product, battery, literature, or packaging reminds you that all electrical and electronic products and batteries must be taken to separate collection at the end of their working life. Do not dispose of these products as unsorted municipal waste: take them for recycling. For info on your nearest recycling point, check with your local waste authority.